

Hardware Quick Reference LANCOM GS-2310P+

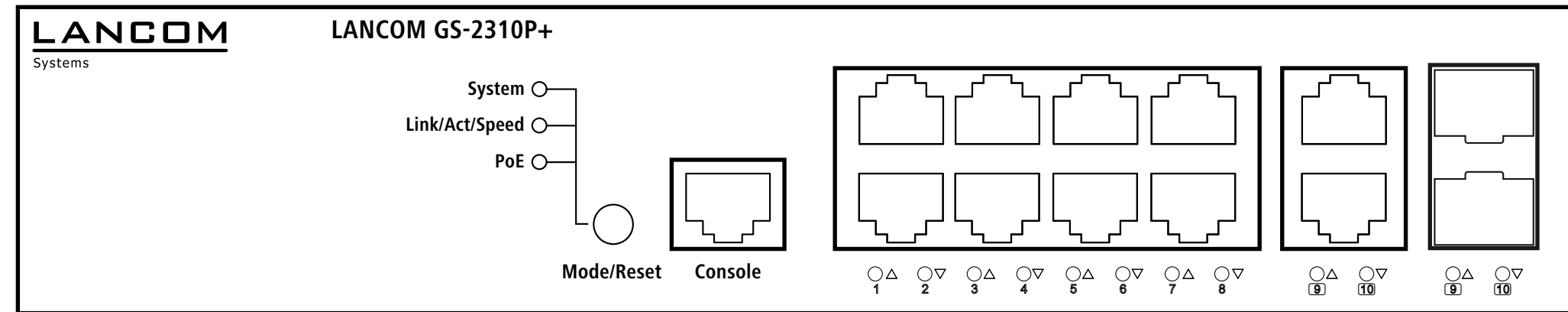

- ① **Configuration interface**
Connect the serial interface (Console) via the included serial configuration cable to the serial interface of the device you want to use for configuring / monitoring the switch.
- ② **TP Ethernet interfaces**
Use Ethernet cables to connect the interfaces ETH 1 to ETH 8 to your PC or a LAN switch.
- ③ **TP Ethernet interfaces (combo ports)**
Use Ethernet cables to connect the interfaces ETH 9 and ETH 10 to your end device or another LAN switch.

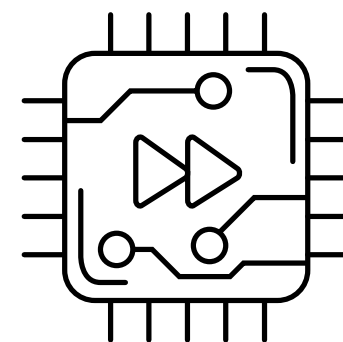
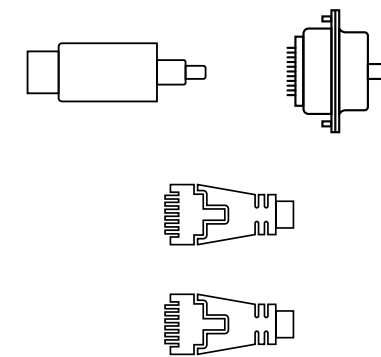

- ④ **SFP interfaces (combo ports)**
Insert suitable LANCOM SFP modules into the SFP combo ports 9 and 10. Choose cables which are compatible with the SFP modules and connect them as described in the module's documentations.
- ⑤ **Power connector (device back side)**
Supply power to the device via the power connector. Please use the IEC power cable supplied or a country-specific LANCOM Power Cord.

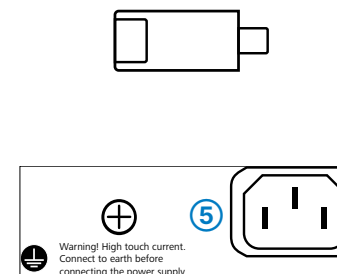

Before initial startup, please make sure to take notice of the information regarding the intended use in the enclosed installation guide!

Operate the device only with a professionally installed power supply at a nearby power socket that is freely accessible at all times.



Please observe the following when setting up the device

- The power plug of the device must be freely accessible.
- For devices to be operated on the desktop, please attach the adhesive rubber footpads
- Do not rest any objects on top of the device
- Keep all ventilation slots on the side of the device clear of obstruction
- Mount the device into a 19" unit in a server cabinet using the provided screws and mounting brackets.
- Please note that support service for third-party accessories is excluded.

Mounting & connecting

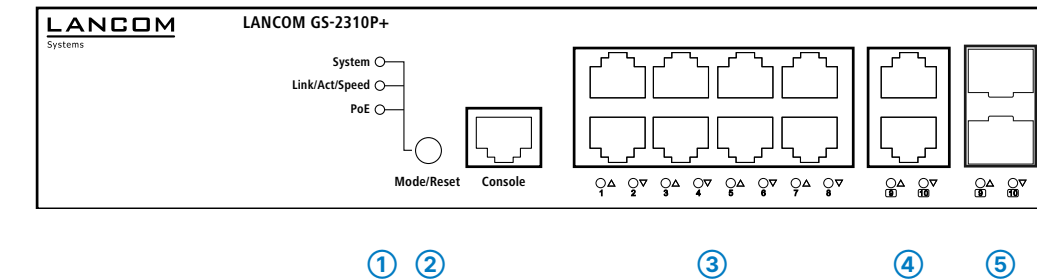

① System / Link/Act/Speed / PoE

System: off	Device powered off
System: green	Device operational
Link/Act/Speed: green	Port LEDs show link / activity status or port speed
PoE: green	Port LEDs show PoE status

② Mode/Reset button

Short press	Port LED display switch
5 seconds pressed	Restart of the device
10 seconds pressed	Reset and restart of the device

③ TP Ethernet ports (combo ports)

Off	Port inactive
Green	Link 1000 Mbps
Orange	Link ≤ 100 Mbps

④ SFP ports (combo ports)

Off	Port inactive
Green	Link 1000 Mbps
Orange	Link ≤ 100 Mbps

Hardware

Power supply	Internal power supply unit (110–230 V, 50-60 Hz), PoE based on IEEE 802.3af and IEEE 802.3at
Power consumption	max. 160 watts
Environment	Temperature range 0–40°C; humidity 10–90%; non-condensing
Housing	Robust metal housing, 19" 1U (220 x 45 x 242 mm > W x H x D) with removable mounting brackets, network connectors on the front
Number of fans	None; fanless design without rotating parts, high MTBF

Interfaces

ETH	8 TP Ethernet-Ports 10/100/1000 Mbps 2 Combo-Ports (TP/SFP) 100/1000 Mbps (SFP) and 10/100/1000 Mbps (TP) 10 concurrent ports in total
-----	--

Package Content

Mounting brackets	Two 19" brackets for rackmounting
Cable	IEC power cord, serial configuration cable 1.5 m

*1) The additional power LED statuses are displayed in 5-seconds rotation if the device is configured to be managed by the LANCOM Management Cloud.

This product contains separate open-source software components which are subject to their own licenses, in particular the General Public License (GPL). The license information for the device firmware (LCOS) is available on the device's WEBconfig interface under "Extras > License information". If the respective license demands, the source files for the corresponding software components will be made available on a download server upon request.

Hereby, LANCOM Systems GmbH | Adenauerstrasse 20/B2 | D-52146 Wuersele, declares that this device is in compliance with Directives 2014/30/EU, 2014/35/EU, 2011/65/EU, and Regulation (EC) No. 1907/2006. The full text of the EU Declaration of Conformity is available at the following Internet address: www.lancom-systems.com/doc